



Denar® iTero® Mounting System Instruction Manual



Denar® iTero® Mounting System Instructions.

1. Create iTero® casts from screening process.
2. Mount casts to the labeled upper and lower base by sliding the casts down over the pins flush against the base of the mounting system.



3. The cast support may be adjusted front to back by making a quarter turn on the support. Once in the position you want, turn back to tighten the support.

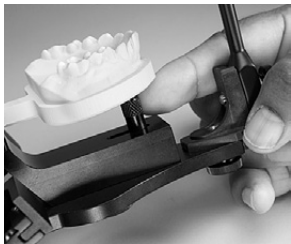

- 4.** Remove the larger thumbscrews currently on the upper and lower member of your articulator.



- 5.** Place the mounting system base on the upper and lower members of the articulator using the locator pins. Holding the mounting system flat against the articulator member, tighten using the smaller thumbscrews provided with the mounting system.



6. You should now be able to go through excursive movements on the articulator.



7. To remove the iTero® casts from the mounting system, hold the mounting system in one hand. Place the index and middle finger of the opposite hand on top of the wings next to the pins. Use your thumb to push up on the small silver pin in the middle. You will then be able to use side to side movement to walk the casts away from the base.



- 8.** To remove the mounting system base, start by removing the upper member of the articulator if possible. Then loosen the thumbscrew enough to create a gap between the articulator member and the base of the thumbscrew.

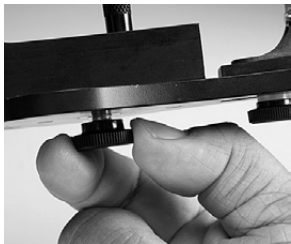

- 9.** Tap on the top of the thumbscrew or rock the mounting system to slightly separate the base from the member. This should create a small gap between the mounting system base and the articulator member. Once the gap is visible, push the adapter base back up flush against the articulator member (removing the gap you just created). This will release the collets from the pins.

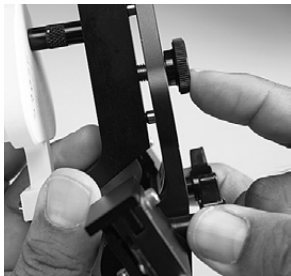

- 10.** Finish removing the thumbscrew and then, with side to side rocking movement, remove the mounting system base.
- 11.** Screw the larger thumbscrews back on to your upper and lower members of the articulator.
- 12.** The mounting system thumbscrews should be stored separately from the base as to not damage the collet system.

The mounting system can be used on any Denar® or Hanau™ articulator except the Mark 300 series. With a Hanau™ articulator with orbitale indicator, the indicator would need to be removed before beginning this procedure. If you plan to use this mounting system on the Hanau™ Wide-Vue articulator, please call 1-800-626-5651 to receive a longer screw for attachment to the upper member of the articulator. Request screw #R00000000.

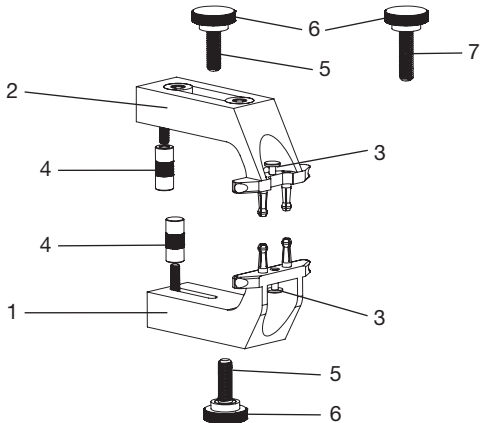

Key #	Part #	Description
1		Lower Base*
2		Upper Base*
3		Mold Release Button*
4	R20011406	Post
5	R3037	Screw, Socket Head Cap
6	R3178	Knob
7	R3138	Screw, Upper Member, Wide-Vue

*Requires Factory Repair



RESTORATIVE ORAL HEALTH

Whip Mix Corporation
361 Farmington Avenue
Louisville, KY USA 40209
Toll-Free: 800-626-5651
Fax: 502-634-7167
www.whipmix.com

Whip Mix®, Denar® and logos are registered
trademarks of Whip Mix Corporation.
©2009 Whip Mix Corporation.